

**Foreign Consultation Center
was closed**

Foreign Consultation Center service provided by Tsukuba International Association was closed on Sept. 30, 2021. From now on please use Tsukuba Inquiry Desk for foreign citizens (on the 5th floor of the City Hall, in the international office). Service can be provided in 13 languages with the use of a tablet. For inquiries: International Association 029-869-7675.

Tsukuba Inquiry Desk for Foreign Citizens

If you have any problems in everyday life, we introduce relevant consultation desks. You can inquire from Monday to Friday, 10:00-12:00, 13:00-17:00. We consult in English, Chinese, Korean, Thai, Russian, Vietnamese, Portuguese, Spanish, French, Tagalog, Hindi, Nepalese, and Indonesian languages.

*Interpretation service is provided via machine. Your privacy guaranteed. No fees required. Interpretation service outside of the City Hall is not provided. Consulting via phone is available in Chinese and English only. No reservation required. (There is charge for phone calls.) Tel.: 029-883-1313.



Call for Tsukuba International Students Staff

Are you interested in translating Tsukuba City newsletters and making presentations about your country at elementary and middle schools? We are looking for international students to work with us for a one-year term from April. For details about requirements, quota, application process, please check the multilingual HP (<http://www.city.tsukuba.ibaraki.jp>). Feel free to apply by submitting the application form and other required documents.

The selection will be carried out through a document review, translation exam and interview.



**Now Hiring Assistant Language
Teachers (ALT) in Tsukuba City
for FY2022**

We are currently recruiting foreign (English) language teachers to assist in elementary, junior high schools, and compulsory education schools in Tsukuba. Contract period is from April 1, 2022 to March 31, 2023. Please check the Tsukuba City Hall multilingual website for details. Please submit the application form along with other required documents by Dec. 21 (Wed.) directly to Educational General Affairs Division or send them via post.

**Municipal and Prefectural Tax Return for FY2022 and Final Income Tax
Return for FY2021**

Same as last year, to reduce congestion at the City Hall, reservation in advance via internet or phone is required.

Details about the reservation will be posted on the Tsukuba City Hall multilingual website.

Tax Return Consultations period and schedule

- ① Municipal and Prefectural Tax and Final Income Tax Return Consultations (tax refund only), **reservation required.** Weekdays through February 1 - 10, 2022. * Unavailable on weekends.
- ② Municipal and Prefectural Tax and Final Income Tax Return Consultations, **reservation required.** Weekdays through February 16 - March 15, 2022 and February 27 (Sun.). * Unavailable on weekends.
- ③ Dispatch Tax Return Consultation (Venue: Kukizaki Community Center and Civic Hall Tsukubane). **No reservation required.**

Eligibility: Municipal and Prefectural Tax Return (for those who do not have access to the City Hall).



Guidelines for Infection Prevention

Even basic preventive measures are effective against highly infectious new variants of the viruses.

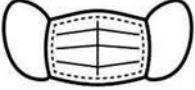

Wear a mask properly

- ✓ Make sure the mask fits to cover your nose without leaving a gap. A mask not covering your nose or placed on your chin cannot prevent infection.
- ✓ Touch only the bands or ties when putting on and taking off your mask.
- ✓ Use high-quality non-woven masks (comparing to cotton or urethane ones, they are proven to be more effective in prevention of micro-droplet infection).



Wash your hands and use hand sanitizer frequently

- ✓ Always wash your hands or use sanitizer, before and after eating, when touching surfaces or objects in public spaces.
- ✓ Keep your nails cut short and remove a watch and rings before washing your hands. Do not forget to wash between fingertips and nails, and between your fingers.
- ✓ After washing your hands rinse them properly with water and wipe with a clean towel or a paper towel.

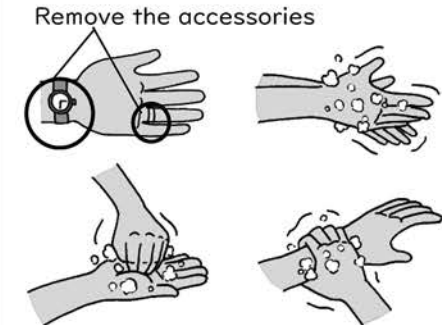

Avoid each of the "Three Cs"

- ✓ When talking do not take your mask off, keep the conversation as short as possible, avoid talking in loud voice.
- ✓ Avoid each of the "Three Cs", aim "No Cs". Keep a safe distance with other people.
- ✓ Avoid closed and small spaces, make sure to ventilate more than usually.

"Three Cs":



Close contact
No mask, loud voice



Crowded places
Crowds, close distance



Closed spaces
Poor ventilation, confined space

Continue to Prevent Infection Even After the Vaccination

Vaccination against COVID-19 is expected to have preventive effect on the onset of the infectious disease, however, it does not guarantee 100% protection. Also, while vaccination is in progress, inoculated people and those who are not (cannot be) vaccinated have to live a social life together. Please continue taking thorough infection prevention measures.

Interval between the vaccine against COVID-19 and other vaccines

As a rule, the vaccine against COVID-19 and other vaccines cannot be given at the same time, but they can be given after 2 weeks interval. Please consult medical staff about details on vaccination interval.

Example: if you were vaccinated against COVID-19 on April 1, you can receive another vaccine from April 15 (after 2 weeks on the same day of the week).

Beware of Seasonal Influenza





Once an epidemic of seasonal influenza begins, it can spread rapidly to many people. In Japan, seasonal outbreaks occur from December to March every year. Preventive measures against COVID-19 are also effective in preventing the spread of seasonal influenza.

Also, it is considered that vaccination against seasonal influenza can protect from severe illness. These vaccines are manufactured using viruses that are expected to be prevalent in each season, therefore, even if you were vaccinated last year, please consider this year's vaccine.

How Can We Lower the Risk of Infection?

Check the risk of infection according to the situations and behavior in your daily life.

Analyzing your behavior and understanding various risks help prevent infection.

	Medium – High Infection Risk	Low Infection Risk
Outdoor 	<ul style="list-style-type: none"> ✓Activities without wearing a mask <ul style="list-style-type: none"> ·face-to-face conversations without keeping enough distance, going to karaoke ·conversations in a closed car or bus with poor ventilation ·close-contact sports activities ✓traveling to other prefectures under state of emergency or semi-emergency ✓touching your eyes, nose, and mouth after holding on to handrails, straps and other things touched by large number of people ▶After touching something touched by an unspecified number of people, wash your hands or use hand sanitizer. 	<ul style="list-style-type: none"> ✓jogging, walking (if there are no people around these activities can be performed without a mask) ✓driving with your family
Indoor 	<ul style="list-style-type: none"> ✓drinking at home, where many people including other families, gathered in a small poorly-ventilated space for a long time ✓sharing towels, tableware, etc. with other people ✓eating and drinking with relatives or friends who don't live with you ✓eating and drinking at a community gathering 	<ul style="list-style-type: none"> ✓ eating at home with family members who live with you ✓eating out with family members who live with you
When eating out 	<ul style="list-style-type: none"> ✓talking in a loud voice when eating or drinking ✓eating and drinking in a group of more than five people ✓removing a mask at times other than eating (when going to the bathroom, paying the bill, making an order, talking after the meal) ✓eating and drinking without keeping distance of at least one meter between people ✓sharing dishes, chopsticks, spoons, etc. ✓night clubs or night club establishments that serve food and beverages, and pub crawls ✓pouring alcohol to others as a gesture of companionship ✓eating with someone for the first time or someone you have not seen in a while ✓eating at restaurants where basic infection preventive measures are not thoroughly implemented ▶When eating out, please make sure to use the restaurants which received certification from the local government (e.g. "Ibaraki's Amabie-chan"). 	<ul style="list-style-type: none"> ✓ sitting diagonally across the table or facing the same direction ✓sitting next to each other while leaving as much space as possible in between ✓ keeping distance with people, talking with a mask on after the meal ✓ using restaurants which implement thorough measures against infections such as installing partitions
At workplace 	<ul style="list-style-type: none"> ✓going to work when you are sick ▶Make sure to rest when you are not feeling well. It is also important to create an environment where people around can take a rest. ✓talking without a mask in changing rooms, rest areas, smoking areas ✓talking when brushing your teeth or gargling in shared bathrooms ✓having a meeting without a mask in a room with no windows ✓riding in a car with several staff members (from other departments etc.) without a mask, no ventilation 	<ul style="list-style-type: none"> ✓working remotely ✓keeping meetings short while wearing a mask in a room with good ventilation ✓working in decentralized work locations ✓attending customers for a short time with a mask on through an acrylic board

City Initiatives Regarding COVID-19 Infection

PCR Test Available in the City Hall (Reservation Required)

Refer to the city website for the details. We notify you of the test results, but **it is not a certified test signed by a doctor which is necessary for overseas travel**. **Eligibility and cost:** city residents who have no symptoms, elementary school students or older, 1000 yen. Those who are commuting to Tsukuba for work or school and have no symptoms 2000 yen. **Schedule:** weekdays from 9.00 to 11.00. *Holidays and period from Dec. 29 to Jan. 3 not available. For details check the city webpage <https://www.city.tsukuba.lg.jp/1012084/1016011.html>

We Provide Supplies to Those Recovering at Home

We provide free supplies such as food and daily necessities to those who recover at home and their families. For details check the city webpage http://www.tsukubainfo.jp/info/2021/0827_1504.html

If You Are Feeling Sick and Worried

If you have symptoms such as a fever and think you might have COVID-19, please consult your family doctor first. If you don't have a family doctor, can't see your doctor, or don't know which medical institution to visit, please call the public health center or Ibaraki Prefectural Office.

To see a doctor when having cold symptoms

Fever, cough, fatigue, sore throat, runny nose, headache, diarrhea, loss of taste or smell, shortness of breath, etc.

if you **have** a family doctor

after consulting your doctor, follow further instructions

if you **don't have** a family doctor

Call the consultation center and check medical institutions you can visit:

Tsukuba Public Health Center ☎029(851)9287
Ibaraki Prefectural Office ☎029(301)3200

Visit a medical institution after a phone consultation

Recommendations for visiting a medical institution

- ✓ do not visit directly, make a phone call first
- ✓ make sure to wear a mask
- ✓ avoid public transportation as much as possible, use private transport

We Ask for Your Cooperation in Tax Payment by the Due Date

Taxes are an important source of revenue for various resident services, such as welfare, education, road maintenance, etc. Tax payment delinquency will make it impossible to secure a budget, and therefore we will be unable to provide sufficient resident services. We ask for your cooperation in paying taxes on time.

Please use bank transfer to complete the tax payment

In Tsukuba city we promote bank transfer as a payment method. It is convenient because once you applied, you will not forget about the payment and can pay without going out. Also, it is possible to pay in cash at bank counters or City Hall desks, convenience stores or via smartphone apps.

* In case the tax amount exceeds 300,000 yen for each period, payment slips cannot be used at convenience stores or smartphone app payments. Also, additional fees may apply.

If you don't pay the city tax

The day after the due date the calculation of penal interest will start. The later the payment is, the larger the penal charge becomes. If payment is not completed within a certain period, a reminder will be sent according to the Local Tax Law. Also, the law states that 'if the payment was not completed within 10 days from the date of sending the reminder, the property of the delinquent must be seized'. If you have means to pay, but don't complete the payment after receiving the reminder, upon legal property investigation (deposit and savings survey, salary inquiry to work) your property will be seized. These measures are taken to maintain tax fairness to those who paid on time.

If you are having difficulty paying tax, please contact us as soon as possible

If you are having financial difficulties and find it hard to pay your tax, please contact Tax Division in the City Hall as soon as possible. We will ask the details of your payment difficulties, and if they are due to the 'inevitable reasons', we will consult you about relevant payment method etc.

Example of inevitable reasons

Eligible: unemployment, loss of profit from business, medical treatment of the taxpayer or their families.

Not eligible: loan repayment, life insurance payment, etc.

Please check the multilingual HP for the details on tax payment deadlines and hospitals that are open on holidays

This newsletter is available in English, Chinese, Korean, Thai, Spanish, Portuguese, Vietnamese, Indonesian languages.

Please recommend it to your friends. It is distributed at stations in Tsukuba city, Iias, BiVi, libraries, etc.

